

HOSEBED CAPACITIES

① 800' OF 5.00" D.J. POLY HOSE

② 150' OF 1.75" D.J. POLY HOSE (UPPER)

400' OF 2.50" D.J. POLY HOSE (LOWER)

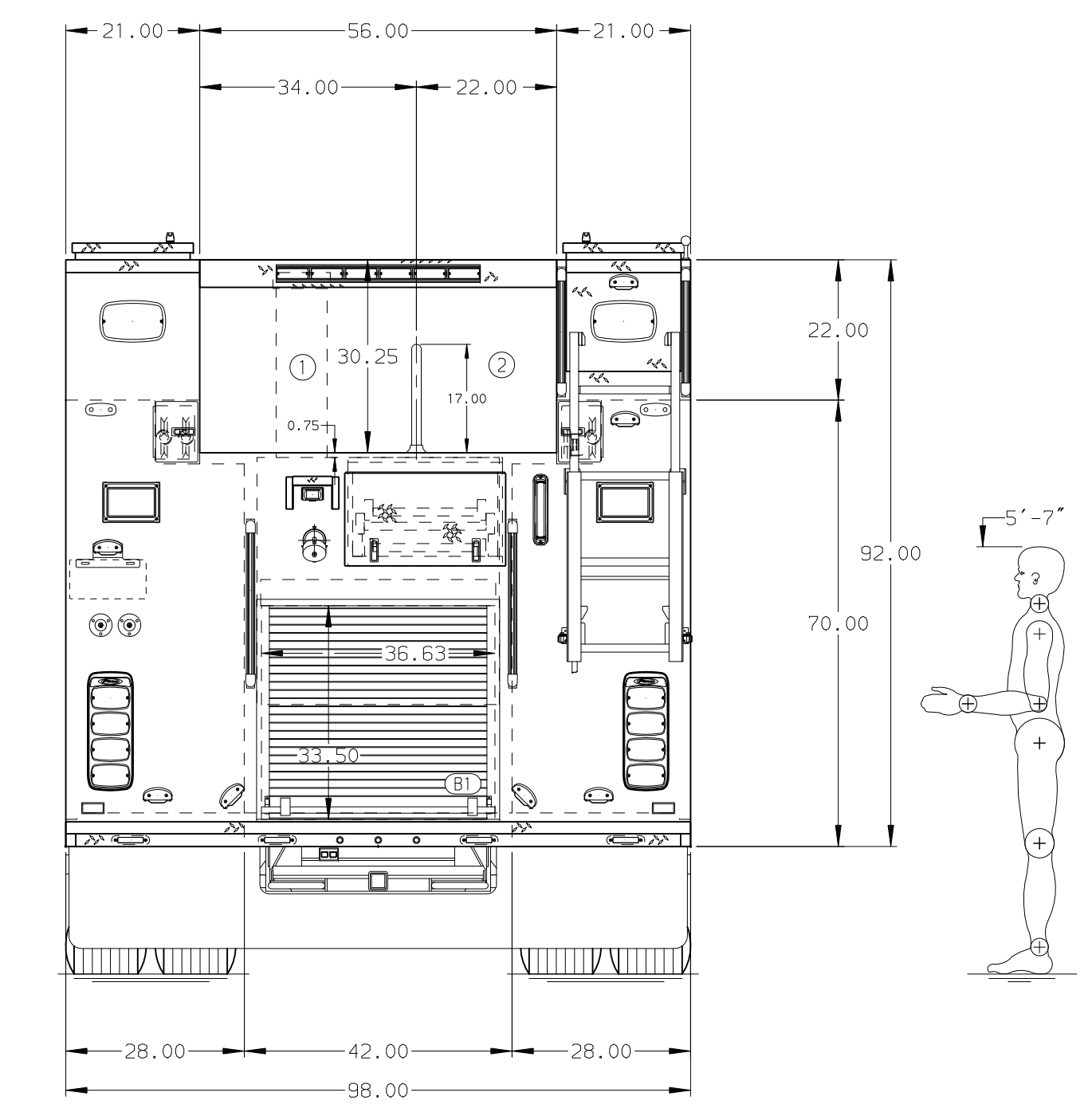
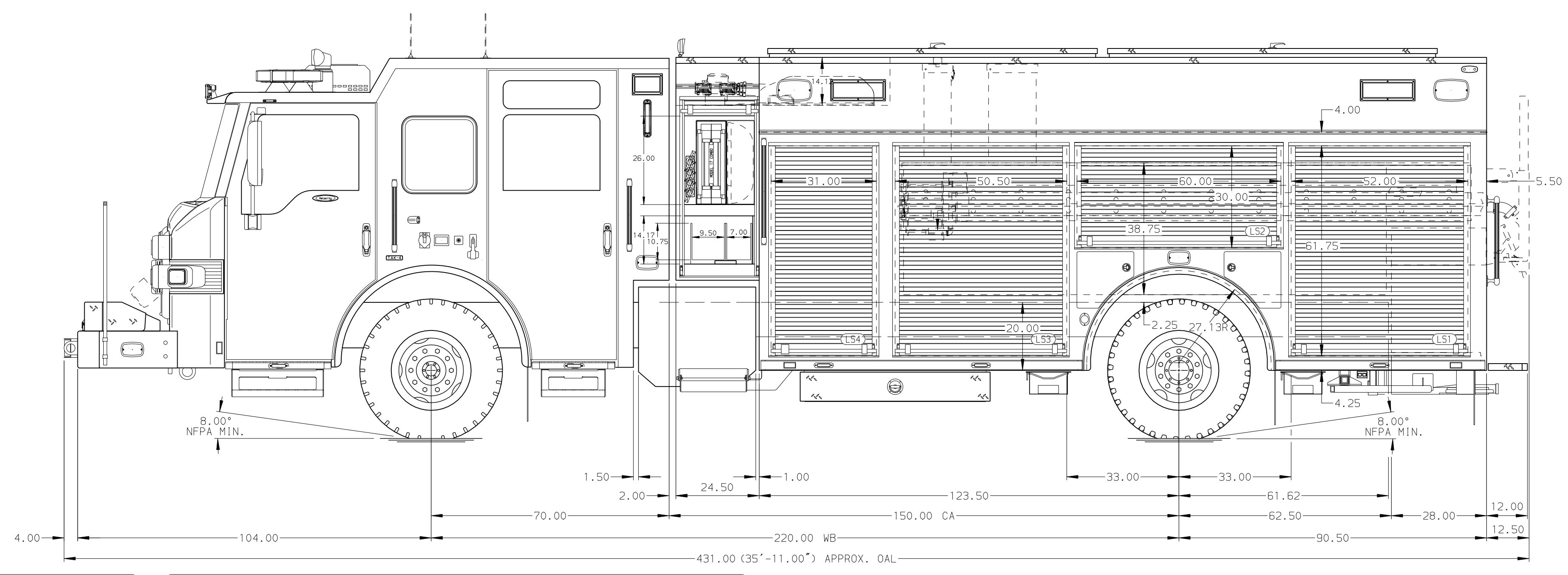

ALUMINUM BODY SIDE ROLL AND FRONTAL IMPACT PROTECTION

NOTE
DIMENSIONS SHOWN ARE APPROXIMATE AND ARE SUBJECT TO MINOR DEVIATIONS AS MAY OCCUR OR BE NECESSARY IN CONSTRUCTION. MINOR DETAILS NOT SHOWN.

CUSTOMER APPROVAL				Pierce MANUFACTURING INC.		JOB NO.	PRELIM
APPROVED BY: _____						SCALE	DATE
DATE: _____						1:24	
CHASSIS DATA		TITLE	1500-D-530P, 500 GAL WATER W/30 GAL FOAM CELL				
MAKE		FOR	214" PUC RESCUE BODY, LADDERS THRU TANK.				
PIERCE		MONSEY FIRE DISTRICT		BID #604		CHECKED BY	18JAN23
MODEL		FIREMATIC SUPPLY CO, INC		JEREMY COHEN		NPA	19JAN23
REV	DATE	BY	CH	VELOCITY	DWG NO.	SHEET SIZE	SHEET NO.
-	-	-	-	-	70274	D	1 OF 1